

# ROSEMOUNT 2130 VIBRATING FORK LIQUID LEVEL SWITCH (THREADED)

REVISION TABLE			
REVISION	ECO NO.	APP'D	DATE
AD	RTC1080315	O. ISAKSSON	2/10/23
DESCRIPTION			
UPDATE TABLE DIMENSIONS.			

**HIGH TEMP. EXTENDED LENGTH (NPT)  
(ALUMINUM OR SST HOUSING)**

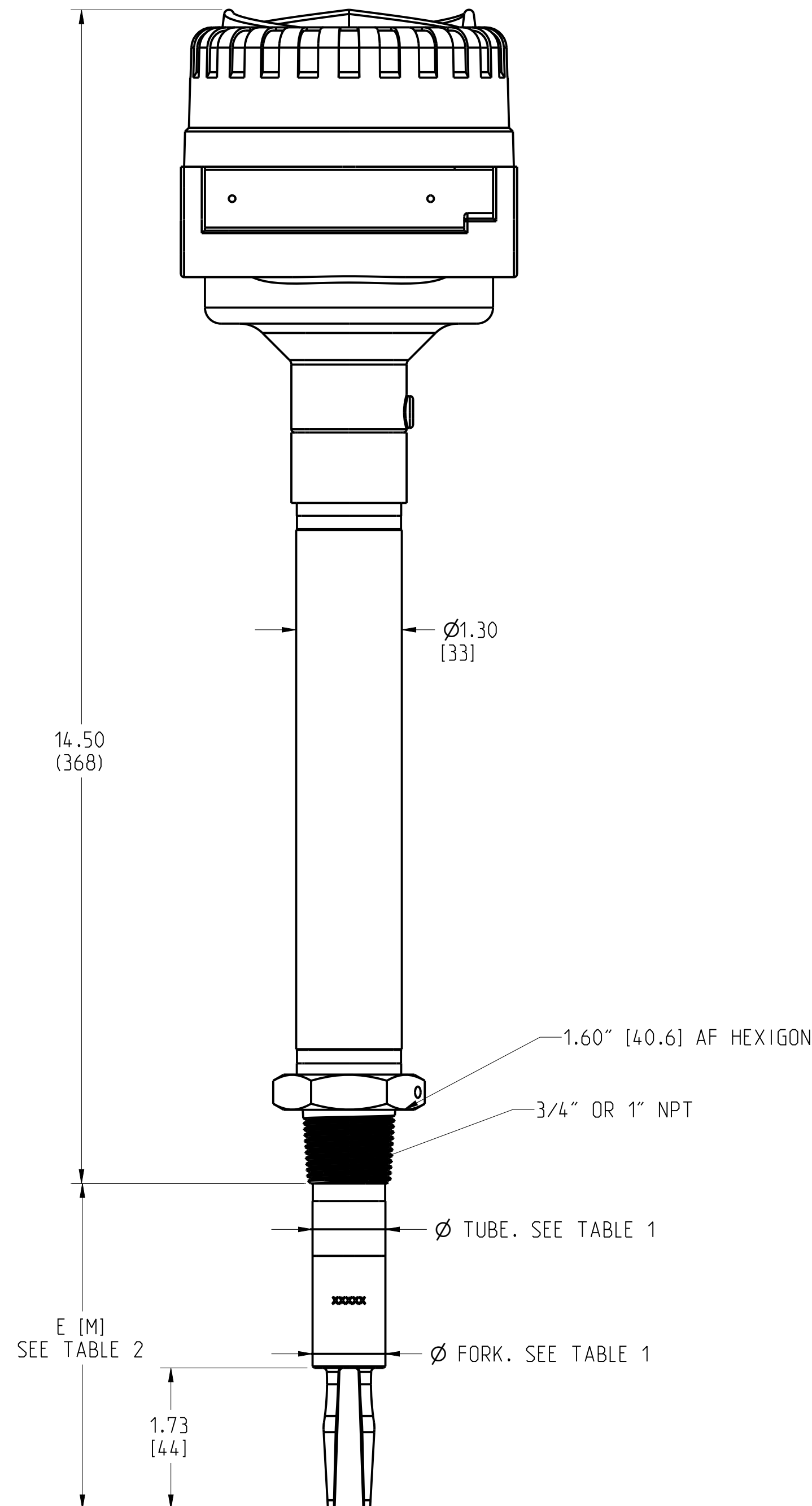

**HIGH TEMP. WITH STANDARD LENGTH (NPT)**

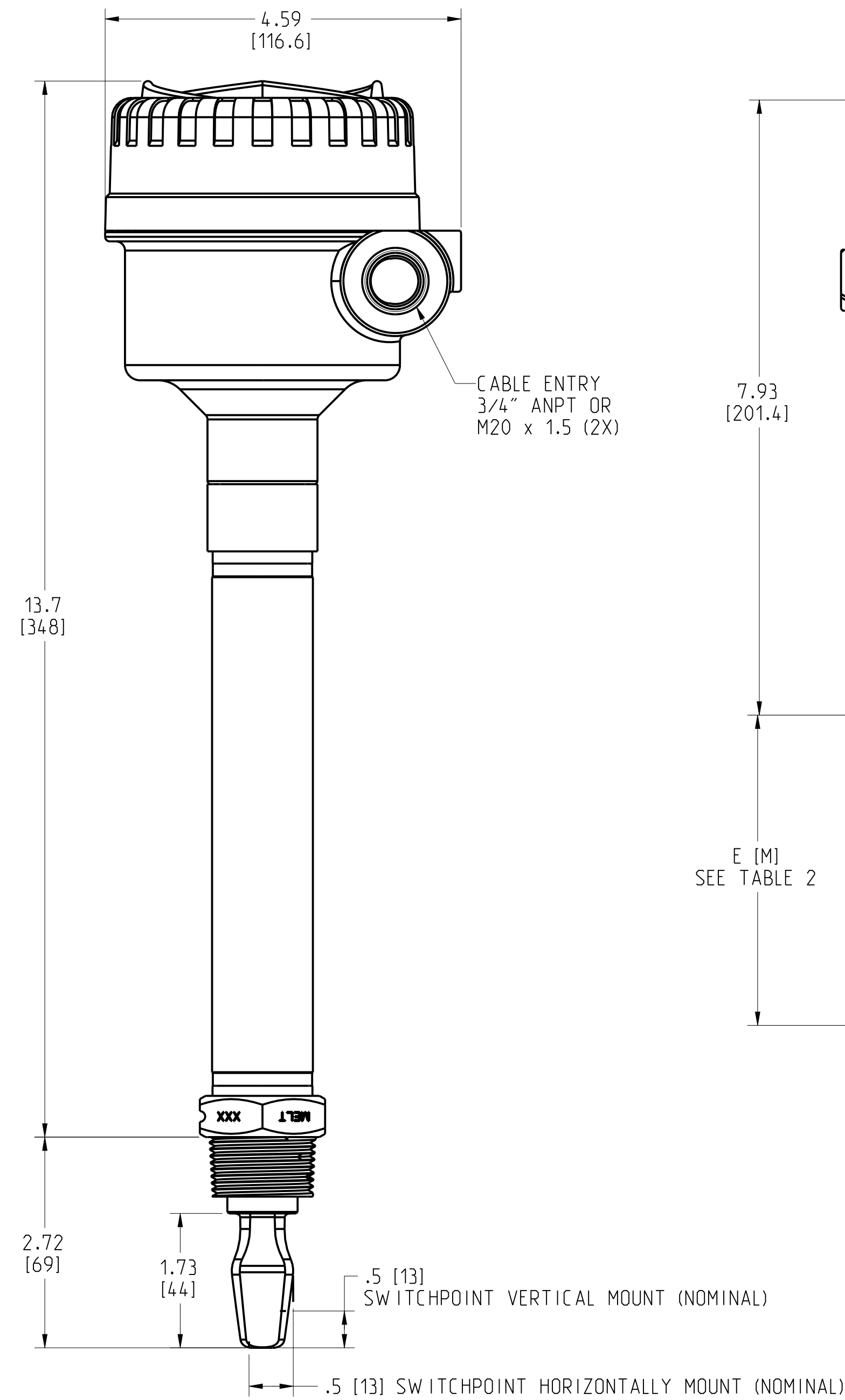

**MID-RANGE TEMP. WITH EXTENDED LENGTH (NPT)  
(ALUMINUM OR SST HOUSING)**

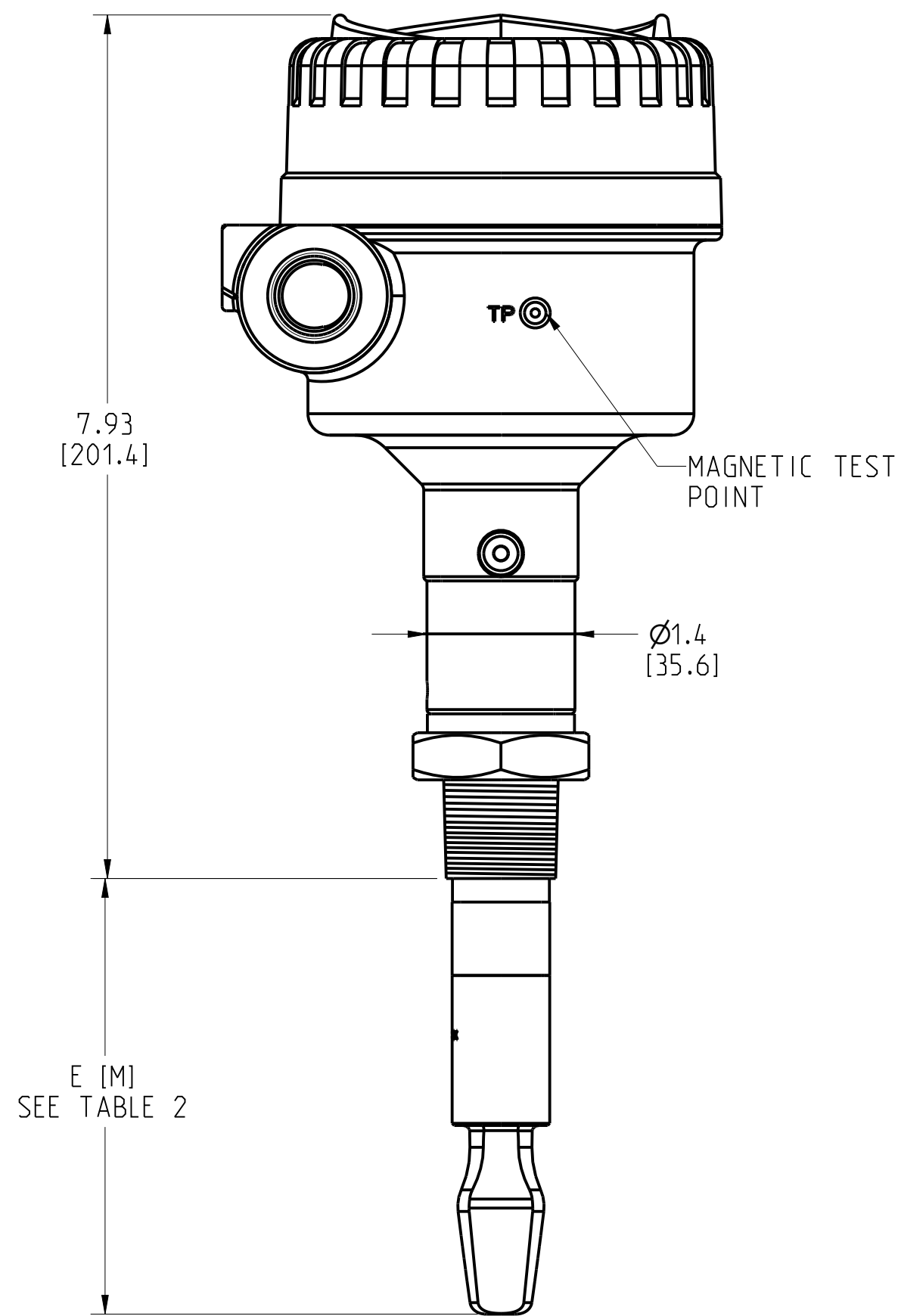

**MID-RANGE TEMP. WITH STANDARD LENGTH (NPT)**

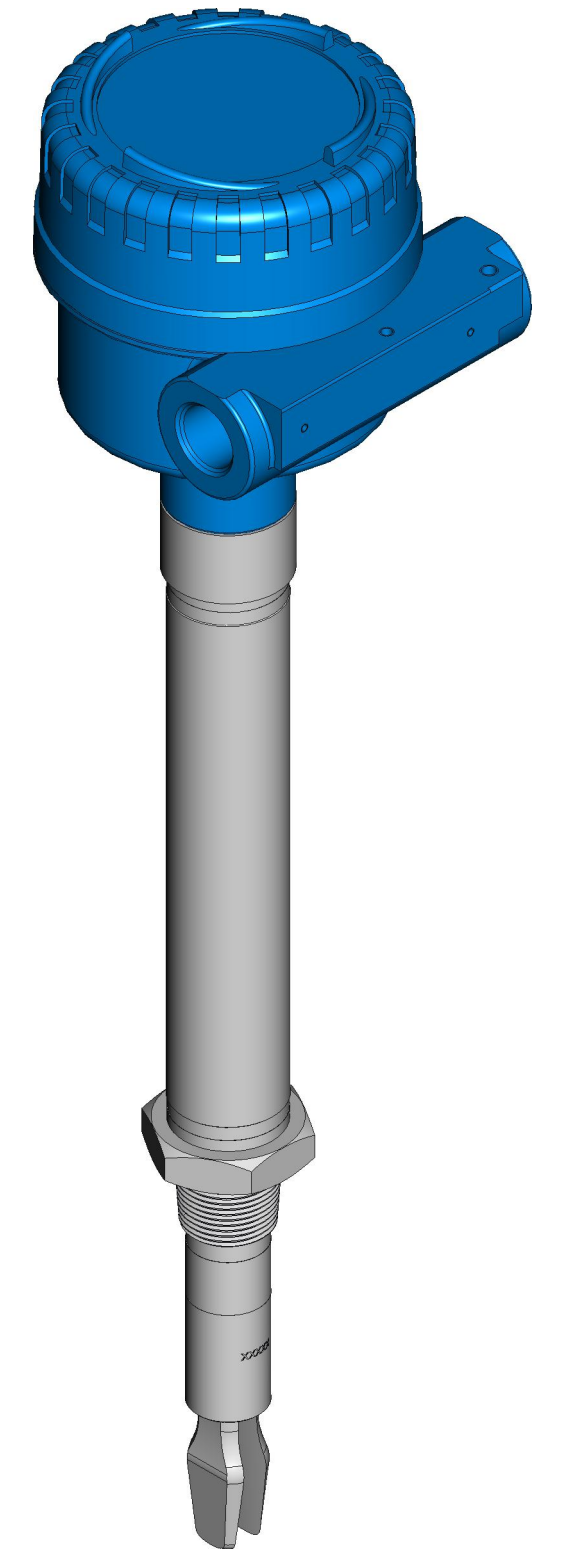
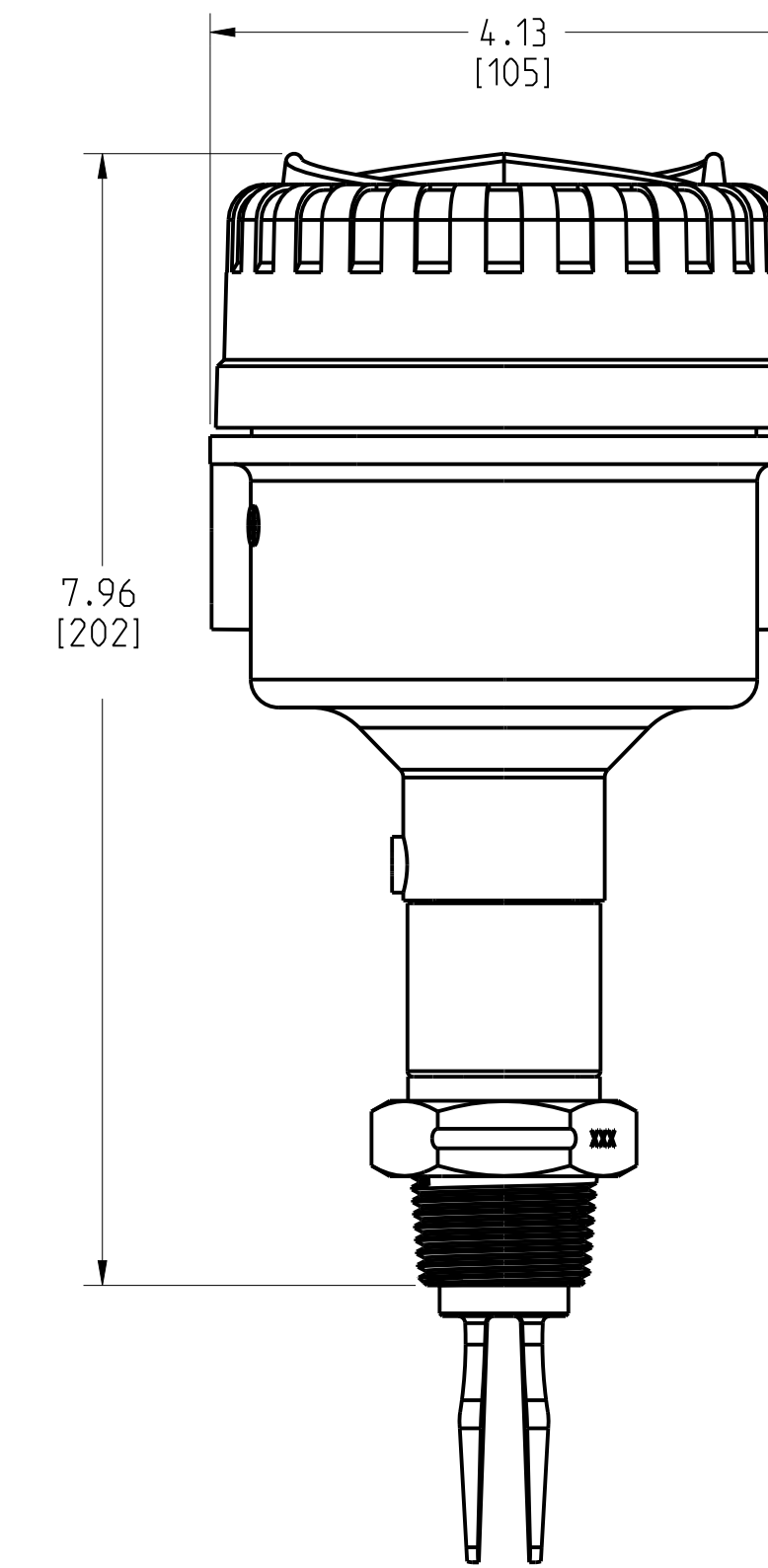

1" BSPP O-RING ONLY

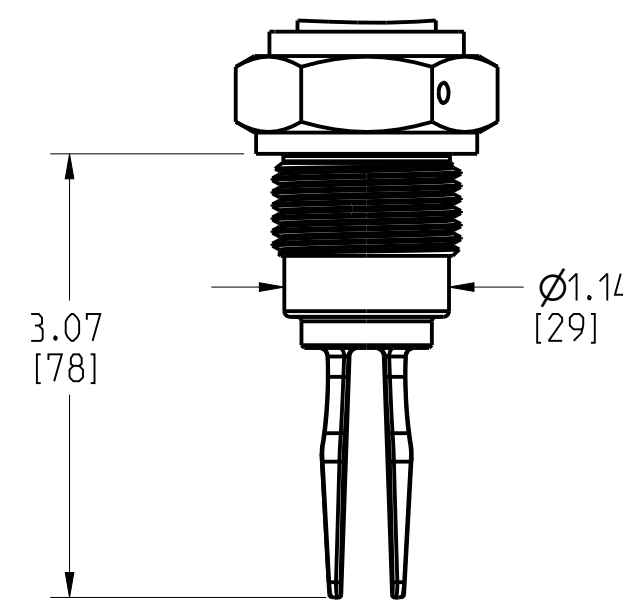

1" BSPP ONLY  
BSPP O-RING FORK

BSPT THREAD

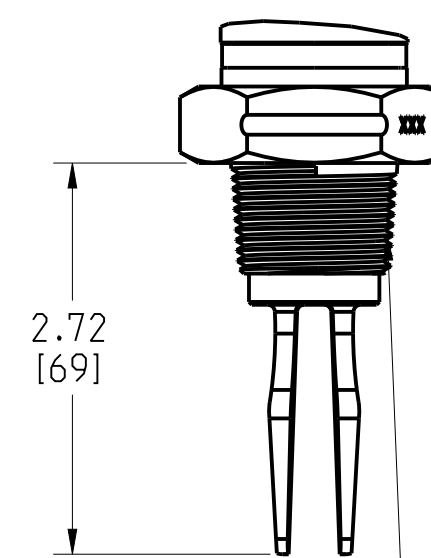

BSPP THREAD

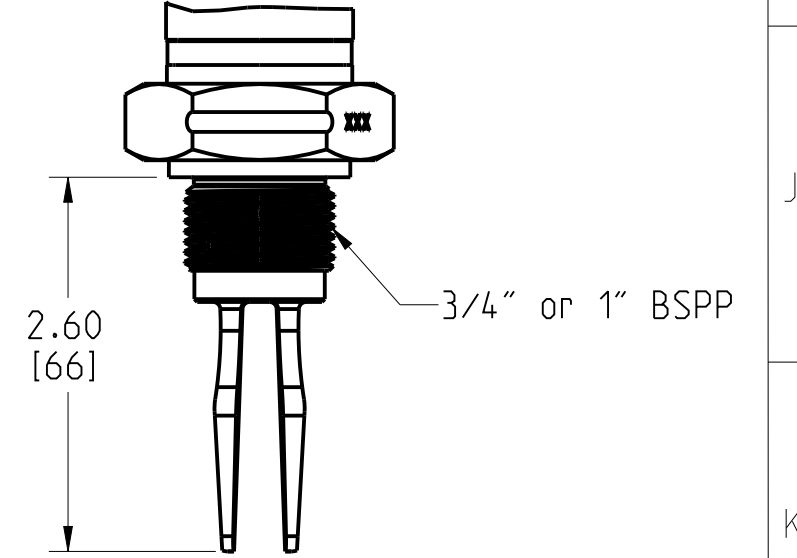

AVAILABLE AS EXTENDED FORK.  
VIEWS SHOW ONLY STANDARD LENGTH

THREAD	STANDARD LENGTH	MIN LENGTH E	MAX LENGTH E
3/4"	1.73 [44]	3.75 [94]	157.5 [4000]
1"	1.73 [44]	3.75 [94]	157.5 [4000]
O-RING SEAL (1" BSPP)	1.73 [44]	—	—

EXTENDED FORK LENGTH AVAILABLE FOR NPT/BSPT/BSPP

THREAD SIZE	TUBE MATERIAL	EXT TUBE MAX O/D	FORK TUBE MAX O/D	NOTE
3/4"	316/316L	.9 [22.8]	.9 [22.75]	1.
1" & 2"	316/316L	1.13 [28.8]	1.11 [28.1]	1.
3/4"	ALLOY C/C-276	.85 [21.6]	.9 [22.75]	1.
1"	ALLOY C/C-276	1.06 [26.9]	1.06 [26.8]	1.

<sup>1</sup>Weld between extension tube and fork tube locally add up to 0.4 [1] to largest tube dia.

©2015 ROSEMOUNT INC.  
ROSEMOUNT INC. ACCEPTS  
THIS ACCORDANCE WITH  
ROSEMOUNT ENGINEERING  
SPECIFICATIONS.  
REFERENCE ROSEMOUNT  
PRODUCT SHEETS FOR  
PRODUCT SPECIFICATIONS.  
CLICK HERE

3RD ANGLE

**EMERSON**

TITLE  
**ROSEMOUNT 2130  
TYPE I DRAWING**

DR. J. ARMSTRONG	6/1/21	DRAWING NO.	02130-7001
APP'D O. ISAKSSON	6/1/21		

CAD MAINTAINED: (PRO/EI) SHEET 1 OF 3

# ROSEMOUNT 2130 VIBRATING FORK LIQUID LEVEL SWITCH (FLANGED)

HIGH TEMP. EXTENDED LENGTH FLANGE  
(ALUMINUM OR SST HOUSING)

HIGH TEMP. WITH STANDARD LENGTH FLANGE

MID-RANGE TEMP. WITH EXTENDED LENGTH FLANGE  
(ALUMINUM OR SST HOUSING)

MID-RANGE TEMP. WITH STANDARD LENGTH FLANGE

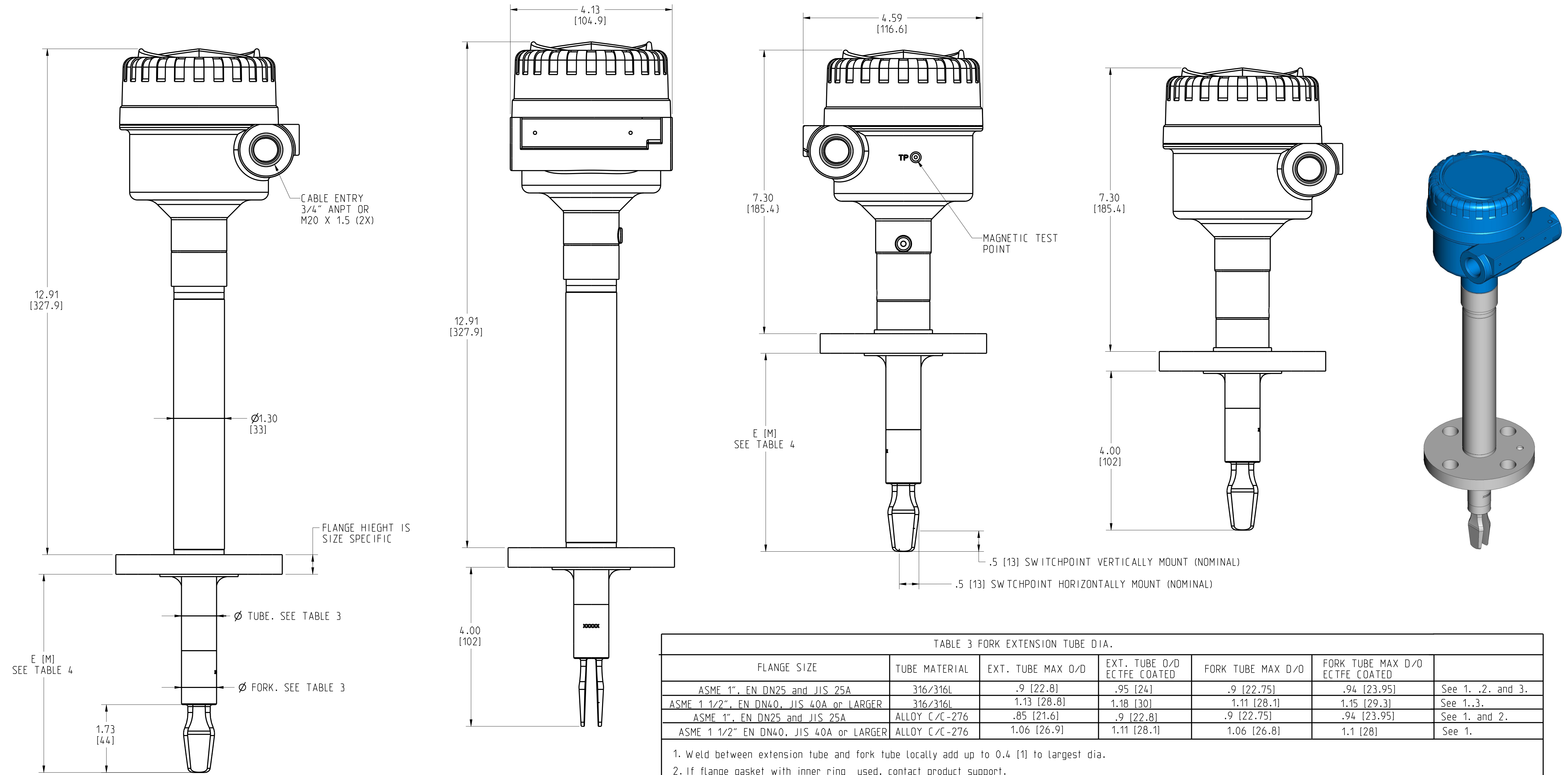

TABLE 3 FORK EXTENSION TUBE DIA.

FLANGE SIZE	TUBE MATERIAL	EXT. TUBE MAX O/D	EXT. TUBE O/D ECTFE COATED	FORK TUBE MAX D/O	FORK TUBE MAX D/O ECTFE COATED	
ASME 1", EN DN25 and JIS 25A	316/316L	.9 [22.8]	.95 [24]	.9 [22.75]	.94 [23.95]	See 1, .2, and 3.
ASME 1 1/2", EN DN40, JIS 40A or LARGER	316/316L	1.13 [28.8]	1.18 [30]	1.11 [28.1]	1.15 [29.3]	See 1..3.
ASME 1", EN DN25 and JIS 25A	ALLOY C/C-276	.85 [21.6]	.9 [22.8]	.9 [22.75]	.94 [23.95]	See 1. and 2.
ASME 1 1/2" EN DN40, JIS 40A or LARGER	ALLOY C/C-276	1.06 [26.9]	1.11 [28.1]	1.06 [26.8]	1.1 [28]	See 1.

1. Weld between extension tube and fork tube locally add up to 0.4 [1] to largest dia.
2. If flange gasket with inner ring used, contact product support.
3. The ECTFE Coating adds 1.2mm to Fork-Tube and Tube Ø. 316/316L only.

TABLE 4 FORK LENGTH

MATERIAL	STANDARD LENGTH	MIN LENGTH E	MAX LENGTH E
SS 316/316L	4.00 [102]	3.50 [89]	157.5 [4000]
ALLOY C (UNS N10002) ALLOY 276 (UNS N10276)	4.00 [102]	3.50 [89]	157.5 [4000]
ECTFE CO-POLYMER COATED	4.00 [102]	3.50 [89]	58.1 [1500]

©2015 ROSEMOUNT, INC.  
ROSEMOUNT INCORPORATES  
THIS INFORMATION WITHIN  
THIS DOCUMENT IN ACCORDANCE WITH  
ROSEMOUNT ENGINEERING  
SPECIFICATIONS.  
UNIT NOTES IN INCHES (mm).

REFERENCE ROSEMOUNT  
PRODUCT SHEETS FOR  
PRODUCT SPECIFICATIONS.  
CLICK HERE

3RD ANGLE

EMERSON

TITLE  
ROSEMOUNT 2130  
TYPE I DRAWING

DR. J. ARMSTRONG 6/1/21 DRAWING NO.  
APP'D O. ISAKSSON 6/1/21

02130-7001

CAD MAINTAINED (PRO/E) SHEET 2 OF 3

# ROSEMOUNT 2130 VIBRATING FORK LIQUID LEVEL SWITCH (TRI-CLAMP)

HIGH TEMP. EXTENDED LENGTH TRI-CLAMP  
(ALUMINUM OR SST HOUSING)

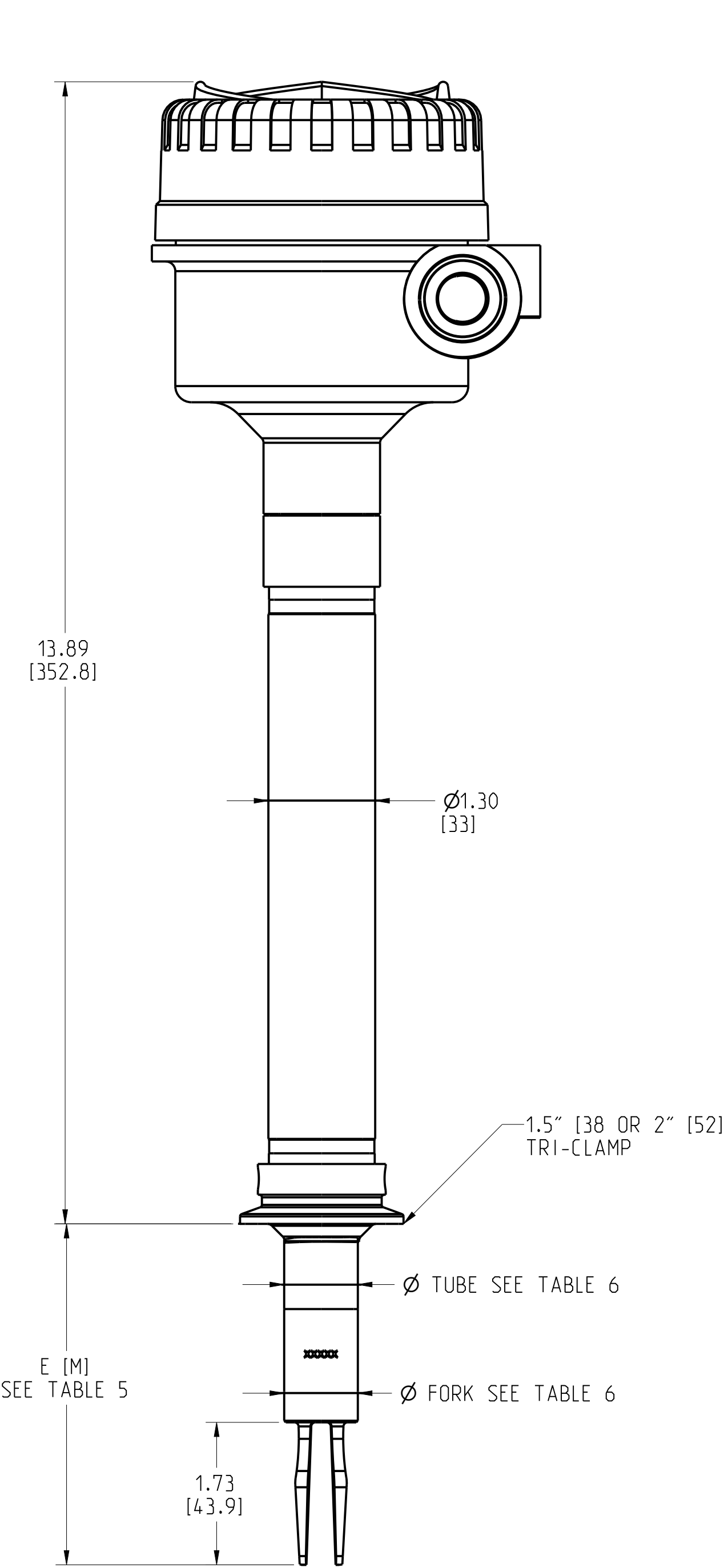

HIGH TEMP. WITH STANDARD LENGTH TRI-CLAMP

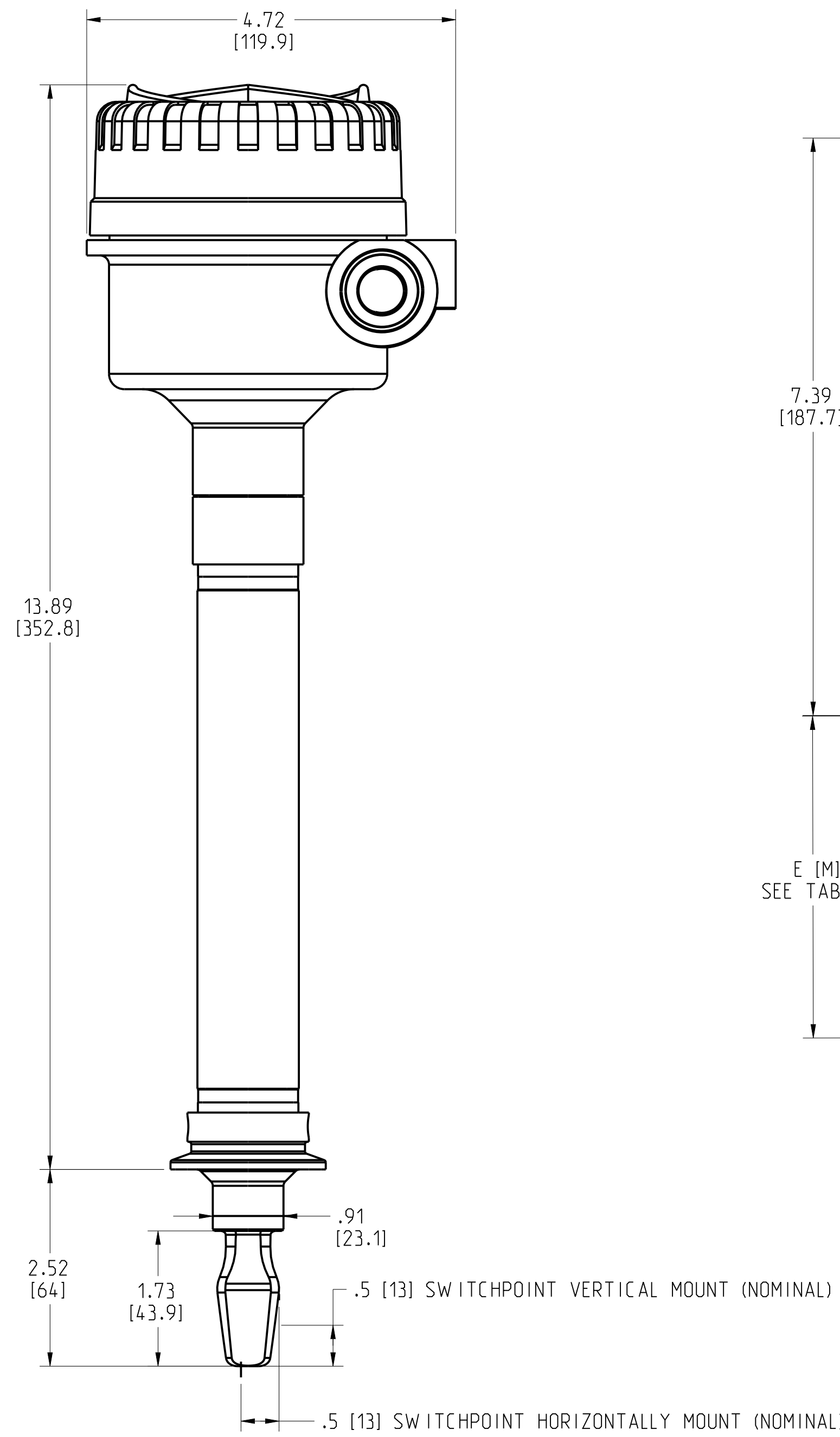

MID-RANGE TEMP. WITH EXTENDED LENGTH TRI-CLAMP  
(ALUMINUM OR SST HOUSING)

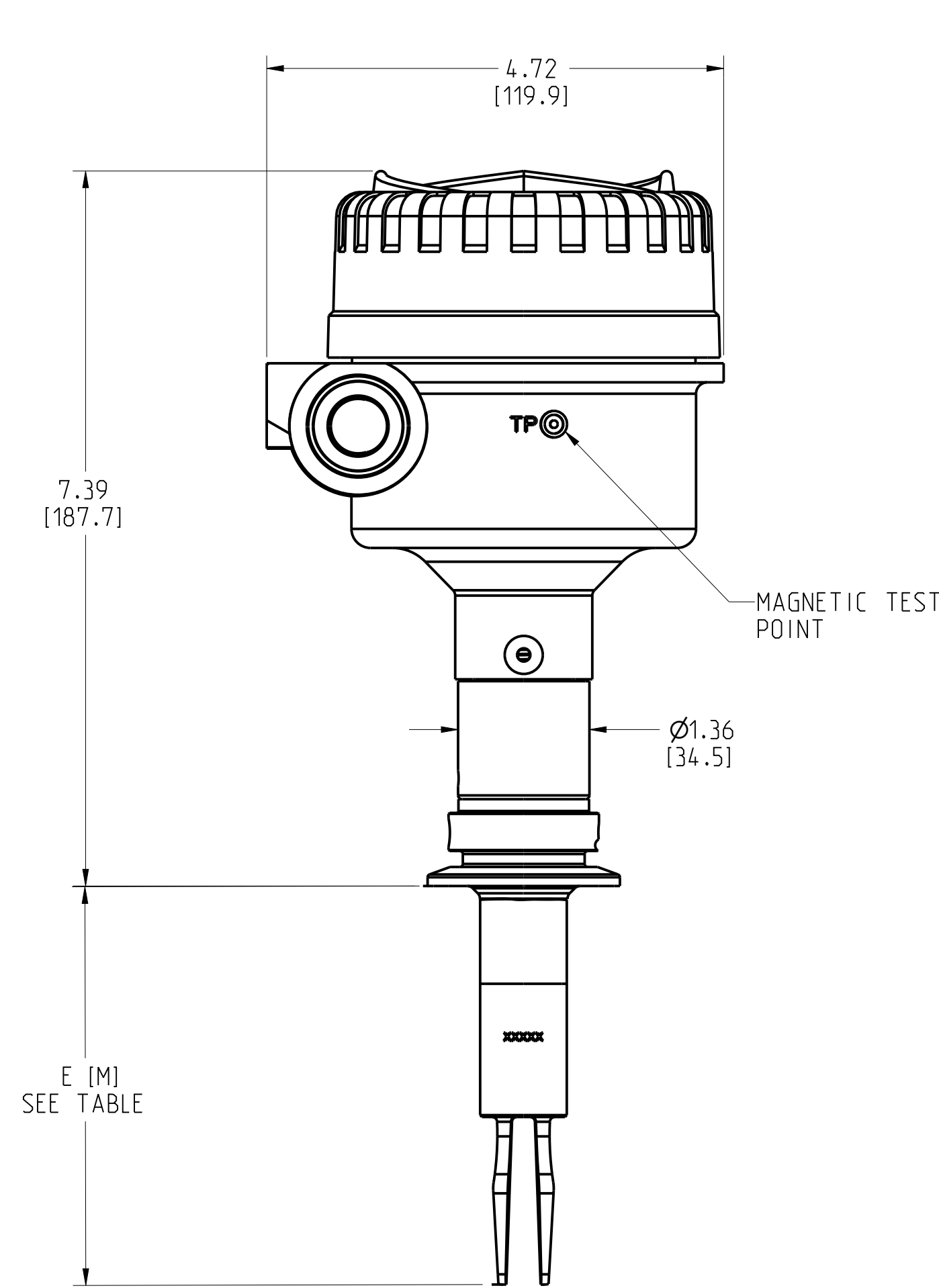

MID-RANGE TEMP. WITH STANDARD LENGTH TRI-CLAMP

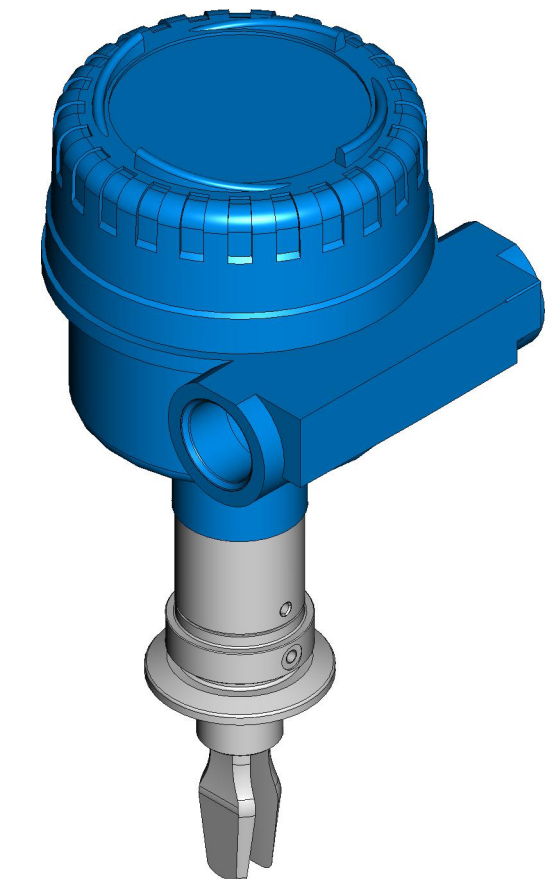
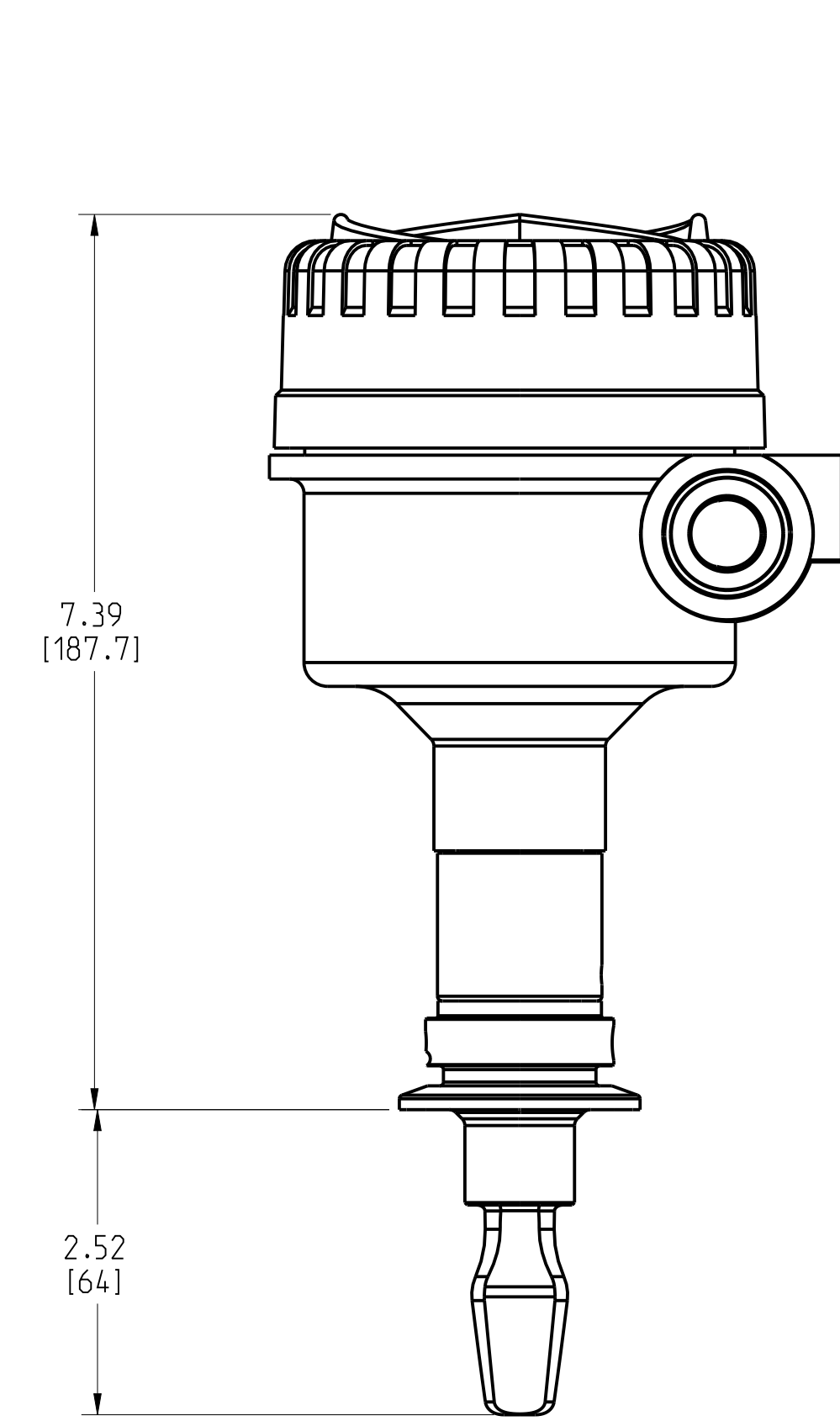

CONNECTION	STANDARD LENGTH	MIN LENGTH E (M)	MAX LENGTH E	POLISHED MAX LENGTH
TRI-CLAMP	1.70 [44]	4.10 [105]	157.5 [4000]	39.3 [1000]

PROCESS CONNECTION TYPE	TUBE MATERIAL	EXT. TUBE MAX O/D	FORK TUBE MAX D/O	NOTE
Tri-Clamp, Surface Finish Codes 1 and 2	316/316L	1.13 [28.8]	1.11 [28.1]	Surface Finish Codes 1, see 1.

1. Weld between extension tube and fork tube locally add up to 0.4 [1] to largest dia.

©2015 ROSEMOUNT, INC. ROSEMOUNT INC. ACCEPTS THIS DRAWING AS IS. THIS DRAWING IS NOT TO BE USED IN ACCORDANCE WITH ROSEMOUNT ENGINEERING SPECIFICATIONS. UNIT NOTES IN INCHES (mm).

REFERENCE ROSEMOUNT PRODUCT SPECIFICATIONS FOR PRODUCT SPECIFICATIONS. CLICK HERE

DR. J. ARMSTRONG 6/1/21 DRAWING NO. 02130-7001

APP'D O. ISAKSSON 6/1/21

CAD MAINTAINED (I/PRO/EI) SHEET 3 OF 3

EMERSON

TITLE ROSEMOUNT 2130 TYPE I DRAWING

3RD ANGLE

SIZE D SCALE NTS