

# De-clutchable Quarter-turn Manual Overrides for Pneumatic Actuation

## MOR Series

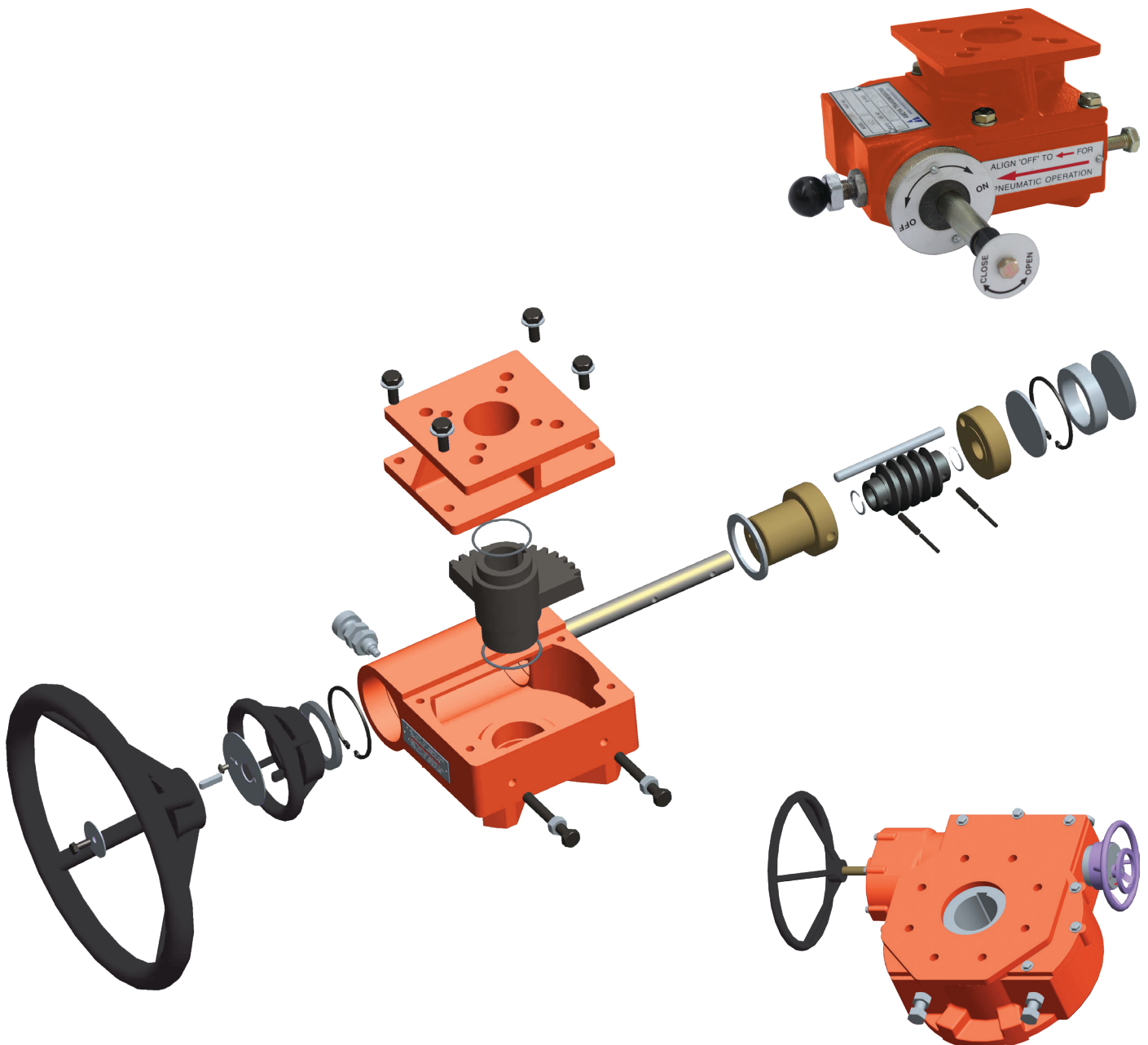

### Standard Features

- Designed for higher efficiencies and lower input effort on handwheel
- 11 models up to 35,000 Nm torque capacity
- Alloy steel worm shafts
- Rugged design
- High performance axial bearings
- Red oxide primer
- Integral top flange (ISO drive coupling available on request)
- Fully sealed gearbox
- Temperature range: -20 °C (-4 °F) to +120 °C (+248 °F)
- Powder coated handwheels for smooth and easy operation
- Stroke 0-90° (+5° adjustable)
- Smooth and easy clutch – declutch mechanism

### Options

- Housing material options (ductile iron / stainless steel)
- Worm shaft, fasteners and hand wheel material option available in stainless steel
- Worm wheel material option available in aluminum bronze
- High temperature variant up to +200 °C (+392 °F) & low temperature variant up to -52 °C (-61.6 °F) available
- Marine application (all exposed fasteners and shafts in stainless steel)
- Finish painting available on request
- Chainwheel operation available

# De-clutchable Quarter-turn Manual Overrides for Pneumatic Actuation

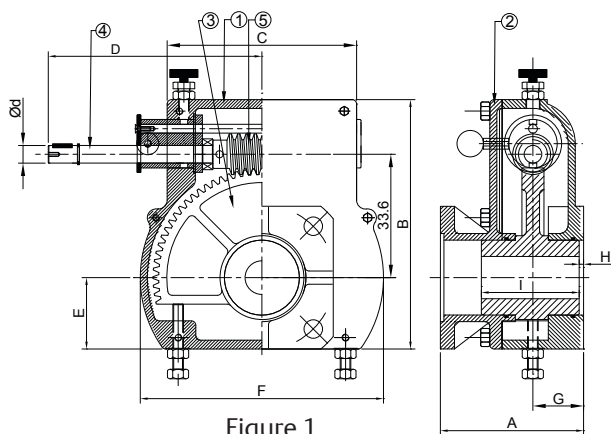
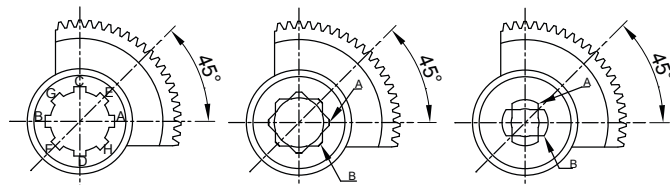

Figure 1



View From Top At Close Position

**Note:**  
Refer to Figure (1) for Models up to "MOR 3.5"  
Refer to Figure (2) for Models above "MOR 3.5"

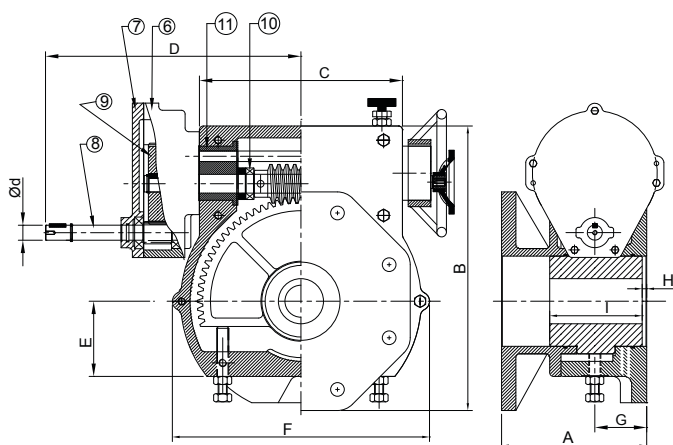

Figure 2

Sr. No.	Description	Material	USA Standard	IS Standard
1	Housing	Cast Iron	ASTM A48-83 30A	IS 210 FG200
2	Cover	Cast Iron	ASTM A48-83 30A	IS 210 FG200
3	Worm Wheel	Ductile Iron	ASTM A70-50 05	SGI 500/7
4	Input Shaft	Carbon Steel	ASTM A576 1045	45C8
5	Worm	Carbon Steel	ASTM A576 1045	45C8
6	Spur Housing	Cast Iron	ASTM A48-83 30A	IS 210 FG200
7	Spur Cover	Cast Iron	ASTM A48-83 30A	IS 210 FG200
8	Spur Pinion	Carbon Steel	ASTM A322 4140	40Cr4Mo3
9	Spur Gear	Carbon Steel	ASTM A322 4140	40Cr4Mo3
10	Thrust Bearing	Special Steel	ASTM A295 52100	-
11	Eccentric Bush	Ductile Iron	ASTM A65-45 12	SGI 400/12
12	Handwheel (Pipe)	Carbon Steel	ASTM A53	IS 2062 Gr B
13	'O' Ring	Buna n	-	Nitrile

Model	Rated Output Torque (Nm)	Mech. Advant. ±10%	Ratio	Turns To Close	Valve Mounting ISO 5211	Max. Drive Bore	Approx. Unit Weight (Kg)	Actuator Mtg. Flange ISO 5211	Recommended Handwheel (mm)	Gear Operator Dimensions									
										A	B	C	D	E	F	G	H	I	Ød
MOR 0.5	250	9	38:1	9.5	F05, F07	25	5	F05, F07	Ø175	83	121	98	126	40	98	28.5	5	48	12
MOR 1	650	9	38:1	9.5	F07, F10, F12	30	9	F07, F10, F12	Ø250	113	175	146	165	58	146	40.5	4.5	75.5	14
MOR 1.5	1000	14.5	60:1	15	F10, F12	40	17	F10, F12	Ø350	146	209	140	144	51	178	51	6	87	15
MOR 2	1500	17	70:1	17.5	F10, F12, F14	50	25	F10, F12, F14, F16	Ø400	150	224	151	230	67	209	44	3	91	16
MOR 2.5	2500	17	80:1	20	F12, F14, F16	60	31	F12, F14, F16	Ø500	162.5	283	215	237	81	276	57.5	9	107	20
MOR 3.5	3500	22	90:1	22.5	F16, F25	80	60	F16 F25	Ø500	185	368	270	265	100	342	69	6	126	20
										193	378								
MOR 5	5000	50	264:1	66	F16, F25	80	70	F16 F25	Ø600	185	368	267	325	100	342	69	10	136	20
										193	379								
MOR 7.5	7500	70	348:1	87	F25, F30	100	105	F25, F30	Ø600	227	457	313	348	100	400	76.5	10	174	20
MOR 10	10000	85	405:1	101.25	F25, F30	100	125	F25, F30	Ø750	227	457	313	435	100	400	76.5	10	174	20
MOR 15	15000	95	460:1	115	F25, F30	110	180	F25, F30	Ø750	235	524.5	331	444	132.5	488	88	10	208	20
MOR 35	35000	260	1282:1	320.5	F25, F30, F35	160	317	F30, F35	Ø750	362	594.5	441	532	146	549	119	12	330	20

World Area Configuration Centers (WACC) offer sales support, service, inventory and commissioning to our global customers.

Contact us at [gears@emerson.com](mailto:gears@emerson.com)

19200 Northwest Freeway  
Houston TX 77065  
USA  
T +1 281 477 4100  
F +1 281 477 2809

©2019 Emerson. All rights reserved.

The Emerson logo is a trademark and service mark of Emerson Electric Co. Emerson reserves the right to amend and change specifications without prior notice.