

FEATURES

- Cylinder equipped with protective bellow

CONSTRUCTION

Bellow	NBR (nitrile)
Retaining ring	Light alloy and POM (polyacetal)
Other parts	Same as standard cylinders



HOW TO ORDER

15-DIGIT PRODUCT CODE

[Configurator - CAD Files](#)

	G	45-	A	-	S	8	----	A00	
Thread connection									Options
G = ISO 228/1									A00 = Without
Product series									Standard stroke (mm) ⁽¹⁾
453									0025 = 25
450									0050 = 50
Revision letter									0080 = 80
A = Initial release									0100 = 100
Diameter (mm) (maximum stroke)									0125 = 125
3 = 32 (250 mm)									0160 = 160
4 = 40 (500 mm)									0200 = 200
5 = 50 (750 mm)									0250 = 250
6 = 63 (1000 mm)									(1) Other strokes on request.
8 = 80 (1000 mm)									
1 = 100 (1000 mm)									
P = 125 (1000 mm) (450 series)									
Q = 160 (1000 mm) (450 series)									
R = 200 (1000 mm) (450 series)									
Rod options 1									Rod options 2
S = No option									8 = Rod bellow
2 = Through rod									
3 = AISI 303 stainless steel rod + rod nut ⁽¹⁾									
4 = AISI 303 stainless steel through rod+ rod nuts ⁽¹⁾									
⁽¹⁾ 316L stainless steel rod, contact us.									



MOUNTINGS

The front flange or top brackets are supplied installed on the cylinder



DETECTORS

reed switch or magneto-resistive type

OPTIONS

The following options and versions cannot be fitted to this cylinder with rod-locking device

Hinge
High temperature version
Oversized rod
Anti-rotation device
Rod locking device

DIMENSIONS (mm)

[Configurator - CAD Files](#)



SINGLE-ROD TYPE CYLINDER
 Profiled barrel cylinder
 Ø 32 to 100 mm

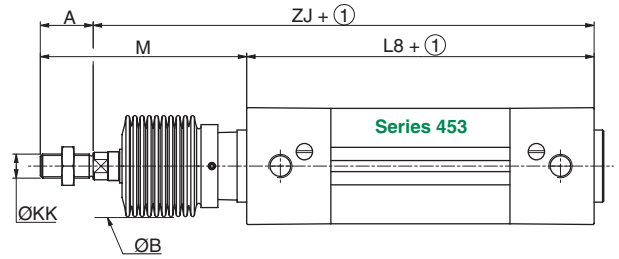

THROUGH-ROD TYPE CYLINDER
 Profiled barrel cylinder
 Ø 32 to 100 mm

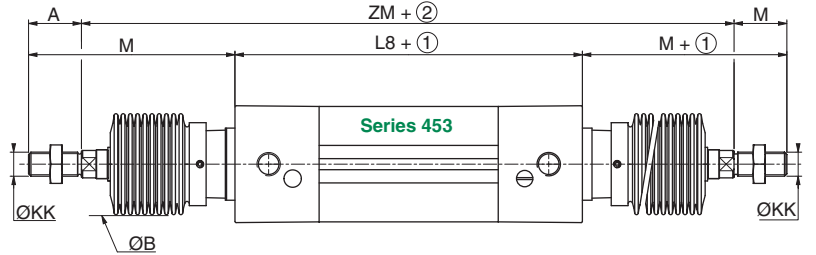

- ① Stroke
- ② 2 x Stroke

Ø (mm)	A	ØB	ØKK	L8	M depending on the stroke: (mm)						ZJ depending on the stroke: (mm)						ZM depending on the stroke: (mm)					
					0-75	76-150	151-250	251-500	501-750	751-1000	0-75	76-150	151-250	251-500	501-750	751-1000	0-75	76-150	151-250	251-500	501-750	751-1000
32	22	41	M10x1,25	94	81	107	127	-	-	-	153	179	199	-	-	212	264	304	-	-	-	
40	24	41	M12x1,25	105	138	138	138	218	-	-	219	219	219	299	-	-	333	333	333	493	-	-
50	32	60	M16x1,5	106	153	153	153	233	313	-	227	227	227	307	387	-	348	348	348	508	668	-
63	32	60	M16x1,5	121	153	153	153	233	313	394	242	242	242	322	402	483	363	363	363	523	683	845
80	40	60	M20x1,5	128	170	170	170	250	330	411	258	258	258	338	418	499	388	388	388	548	708	870
100	40	60	M20x1,5	138	160	160	160	220	280	340	258	258	258	318	378	438	378	378	378	498	618	738



SINGLE-ROD TYPE CYLINDER
 Cylinder with tie rods
 Ø 32 to 200 mm

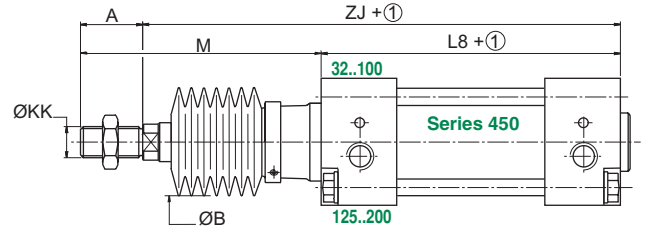

THROUGH-ROD TYPE CYLINDER
 Cylinder with tie rods
 Ø 32 to 200 mm

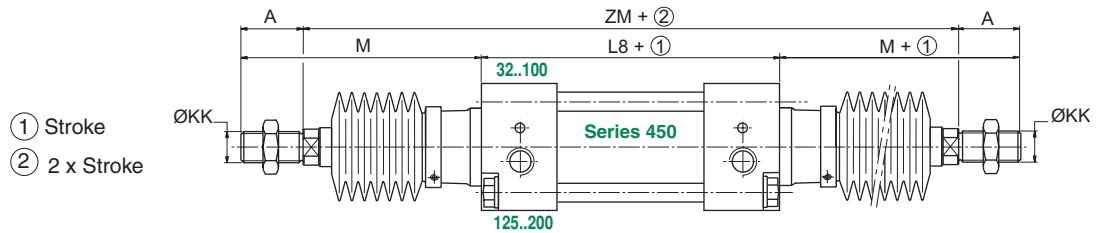

- ① Stroke
- ② 2 x Stroke

Ø (mm)	A	ØB	ØKK	L8	M depending on the stroke: (mm)						ZJ depending on the stroke: (mm)						ZM depending on the stroke: (mm)					
					0-75	76-150	151-250	251-500	501-750	751-1000	0-75	76-150	151-250	251-500	501-750	751-1000	0-75	76-150	151-250	251-500	501-750	751-1000
32	22	41	M10x1,25	94	81	107	127	-	-	-	153	179	199	-	-	212	264	304	-	-	-	
40	24	41	M12x1,25	105	138	138	138	218	-	-	219	219	219	299	-	-	333	333	333	493	-	-
50	32	60	M16x1,5	106	153	153	153	233	313	-	227	227	227	307	387	-	348	348	348	508	668	-
63	32	60	M16x1,5	121	153	153	153	233	313	394	242	242	242	322	402	483	363	363	363	523	683	845
80	40	60	M20x1,5	128	170	170	170	250	330	411	258	258	258	338	418	499	388	388	388	548	708	870
100	40	60	M20x1,5	138	160	160	160	220	280	340	258	258	258	318	378	438	378	378	378	498	618	738
125	54	88	M27x2	160	188	188	188	248	308	368	294	294	294	354	414	474	428	428	428	548	668	788
160	72	88	M36x2	180	222	222	222	266	311	386	330	330	330	374	419	494	480	480	480	568	658	808
200	72	88	M36x2	180	237	237	237	281	326	401	345	345	345	389	434	509	510	510	510	598	688	838