

## Specifications

For other materials or modifications, please consult TESCOM.

### OPERATING PARAMETERS

Pressure rating per criteria of ANSI/ASME B31.3

#### Maximum Inlet Pressure

**Stainless:** 6000 psig / 414 bar

**Brass, Aluminum:** 5000 psig / 345 bar

#### Outlet Pressure Ranges

0-50, 0-150, 0-250 psig

0-3.4, 0-10.3, 0-17.2 bar

#### Design Proof Pressure

150% maximum rated

#### Leakage

Bubble-tight

#### Ambient Operating and Fluid Media Temperature

-40°F to 165°F / -40°C to 74°C

#### Flow Capacity

$C_v = 0.08$

#### Maximum Operating Torque

20 in-lbs / 2.3 N•m

### MEDIA CONTACT MATERIALS

#### Body

316 Stainless Steel, Brass, Aluminum

#### Bonnet

300 Series Stainless Steel

#### 40 Micron Filter

316 Stainless Steel

#### Seat

PCTFE

#### O-Rings

Nitrile, Buna-N

#### Diaphragm

Nitrile, Buna-N

#### Remaining parts

300 Series Stainless Steel

### OTHER

#### Cleaning

CGA 4.1 and ASTM G93

#### Weight (without gauges)

**Stainless, Brass:** 3 lbs / 1.4 kg



TESCOM 26-1500 Series non-venting regulator offers a sensitive, large elastomeric diaphragm design and precision outlet pressure control.

### Applications

- Research labs
- Breathing air diving manifolds
- Low flow purge systems
- Gas and liquid sampling

### Features and Benefits

- Diaphragm design for accurate pressure regulation
- Numerous porting and soft good options are available
- Excellent repeatability
- Non-venting (for venting design, see 26-1600 Series)
- Low operating handknob torque
- Panel mounting (bracket included)
- Available in Stainless Steel, Brass, or Aluminum construction
- Gauge ports are available
- High flow  $C_v = 0.24$  version is available (maximum inlet pressure: 3000 psig / 207 bar)

# 26-1500 SERIES

## 26-1500 Series Regulator Drawings

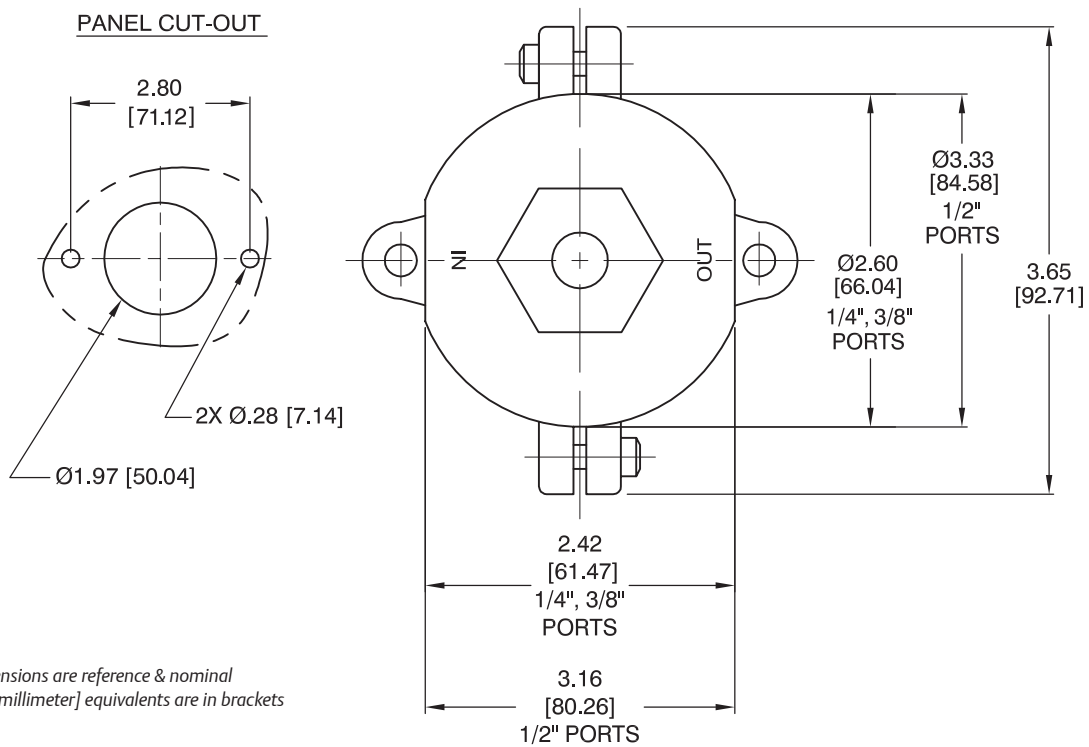
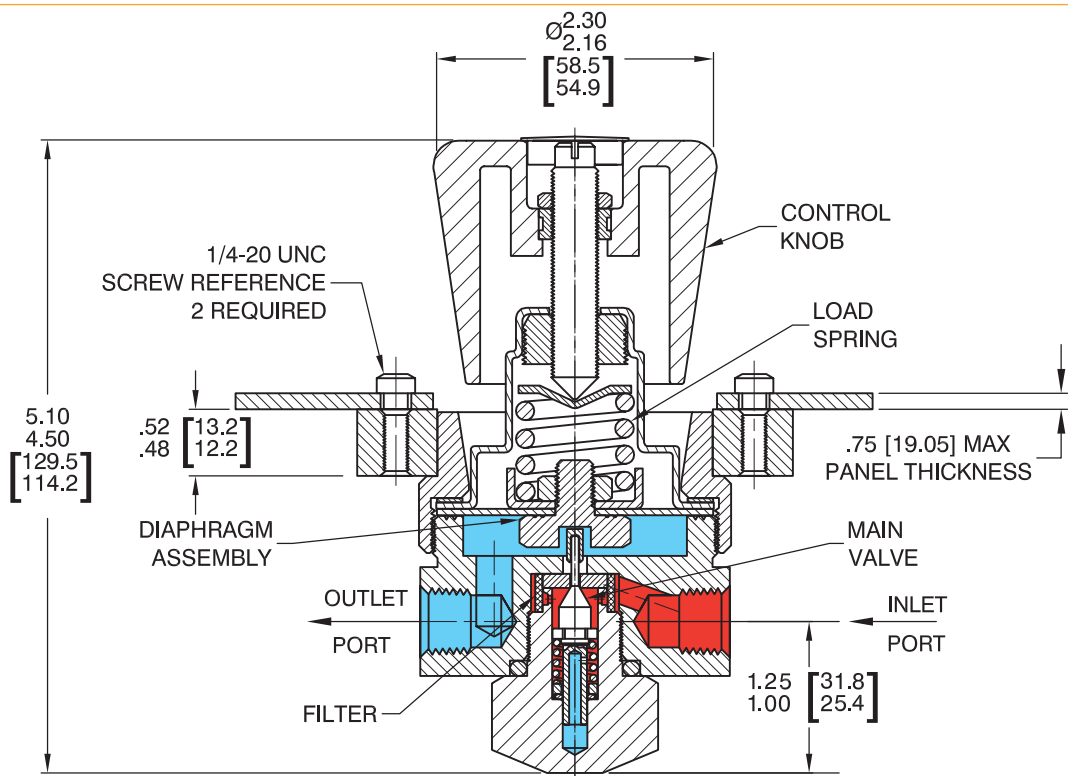

All dimensions are reference & nominal  
Metric [millimeter] equivalents are in brackets

26-1500 Series Regulator Flow Charts

For more information on how to read flow curves, please refer to the Flow Curves and Calculations document (debul2007x012) in the TESCO catalog or on www.tescom.com.

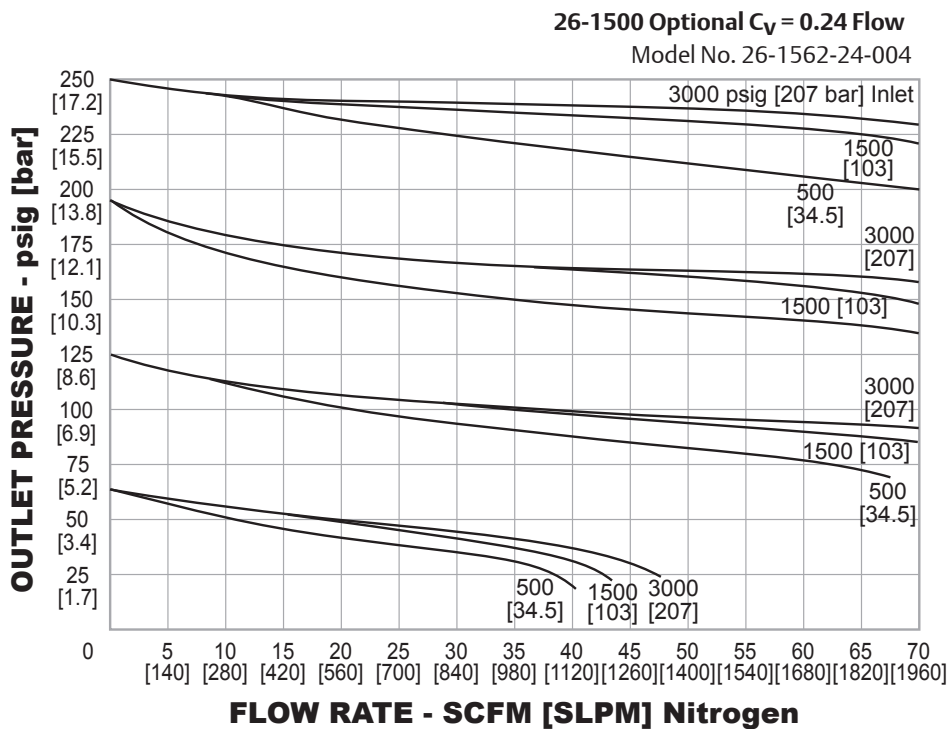
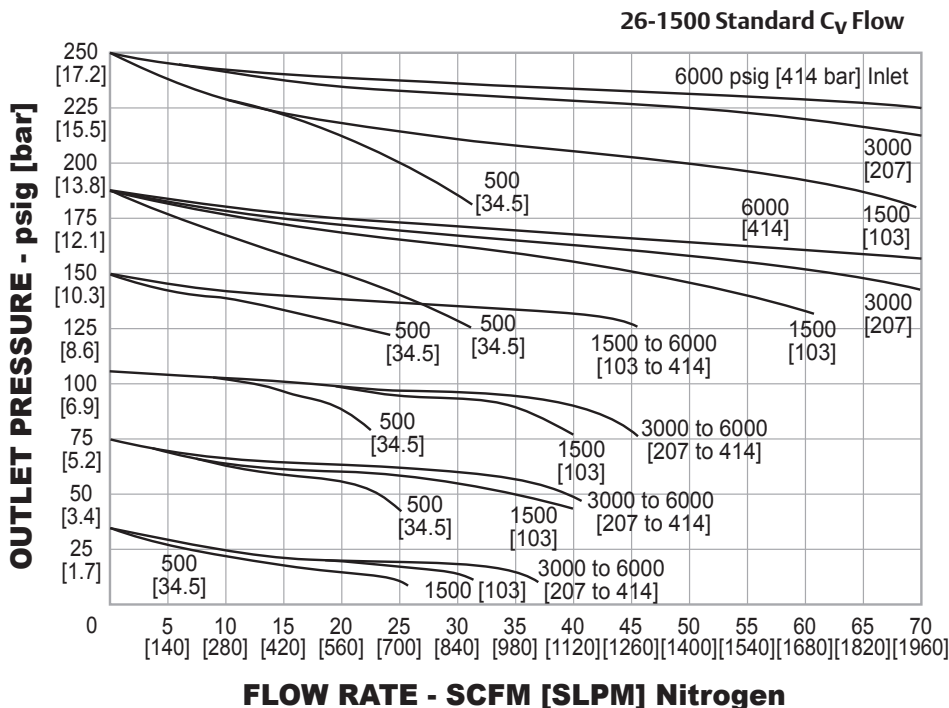

# 26-1500 SERIES

## 26-1500 Series Regulator Part Number Selector



**Learn more about common options.**

For modifications, repair kits and accessories, contact factory.

Example for selecting a part number:

26-15	6	1	-	2	4
BASIC SERIES	BODY MATERIAL	OUTLET PRESSURE RANGES		INLET, OUTLET, AND GAUGE PORT TYPE	INLET, OUTLET, AND GAUGE PORT SIZE
26-15	1 – Brass 3 – 2024 Aluminum 6 – 316 Stainless Steel	0 – 0-50 psig 0-3.4 bar  1 – 0-150 psig 0-10.3 bar  2 – 0-250 psig 0-17.2 bar		1 – SAE  2 – NPTF  3 – MS33649	4 – 1/4"  6 – 3/8"  8 – 1/2" (Stainless Steel only)